

# INSTRUCTIONS FOR REPLACING HYDRO-MIX VI CERAMIC DISC

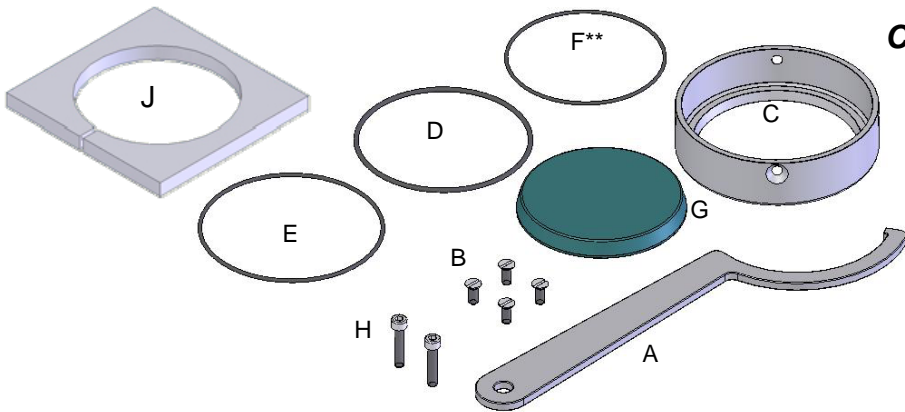

## CONTENTS OF REPLACEMENT KIT

- A. 'C' Spanner.
- B. M5x10 slotted counter-sunk stainless steel screws (x4).
- C. Protection Ring.
- D. 'O' ring (90 I/D x 2.5 section).
- E. 'O' ring (95 I/D x 2.0 section).
- F. 'O' ring (3.239" I/D x 0.070" section). \*\*
- G. Ceramic Disc.
- H. M5x25 stainless steel screws (x2).
- I. Sachet of grease (not shown).
- J. Assembly Jig

## REMOVAL OF CERAMIC DISC

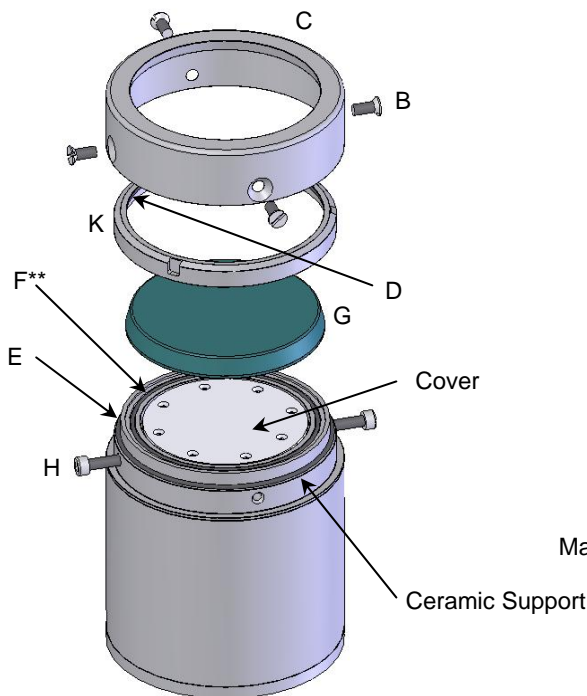

1. Unscrew 4 screws (B) and remove the Protection Ring (C).
2. If there is no mark aligning the Ceramic Securing Ring (K) with the Ceramic Support, draw one (as shown) as a guide for re-assembly.
3. Fit 2 screws (H) in to opposite sides of the Ceramic Support. This will enable the body to be laid flat and prevent it from rotating when unscrewing the Ring (K). Alternatively use Ceramic Tightening Jig (J - Part#0034) in a vice.
4. Use 'C' Spanner (A) to unscrew ring (K). Remove Ring (K) and retain for re-assembly. Remove Ceramic Disc (G) and 'O' rings (D, E and F\*\*).

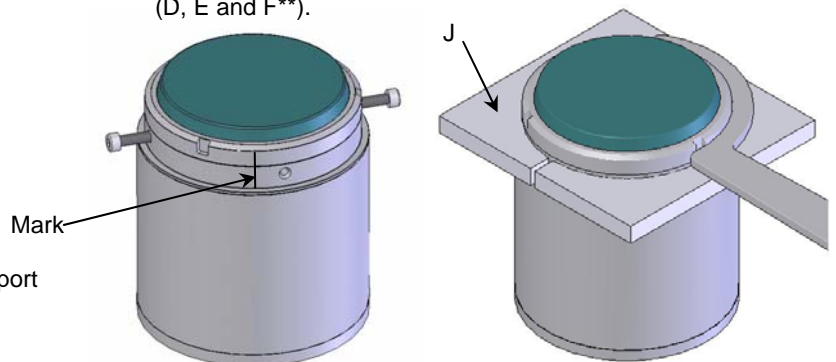

## RE-ASSEMBLY WITH NEW CERAMIC DISC

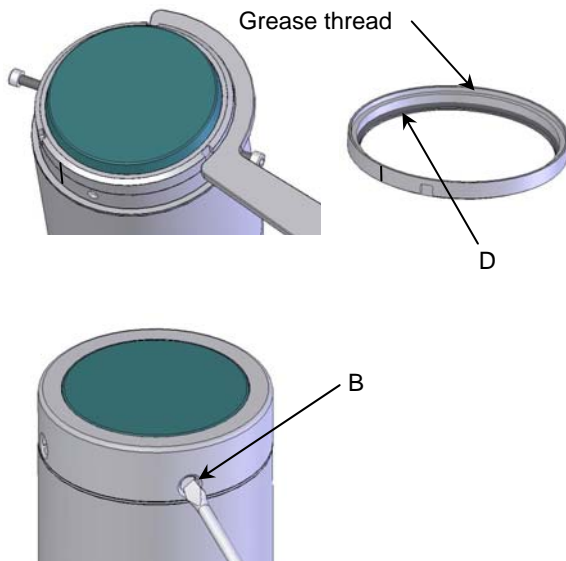

1. Clean and degrease Cover, Ceramic Support and Ring (K).
2. Using the grease supplied (I), lightly grease the 'O' rings D,E and the thread in the Ceramic Securing Ring (K).
3. Place 'O' ring (E) over the Ceramic Support to the base of the thread.
4. Grease 'O' ring (F) with the grease (I) and place in the groove around the Cover. \*\*
5. Place Ceramic Disc (G) over the Cover and locate it in the recess of the Ceramic Support.
6. Place 'O' ring (D) in to the groove at the base of the thread in the Ceramic Securing Ring (K)
7. Place Ring (K) (with the 'O' ring in place) over the Ceramic and Ceramic Support. Carefully tighten using the 'C' Spanner so that the two marks line up. This is the minimum tightness recommended. If possible tighten the Ring further.
8. Place the Protection Ring over the Ceramic and secure with 4 screws (B) ensuring they are properly tightened.
9. Recalibrate the sensor to 'air and water' to ensure the sensor output characteristics remain unchanged (See Hydro-Com User Guide HD0273).

\*\* Early models may not have a groove in the Ceramic Support for o-ring 'F'. On these models omit o-ring 'F'.